

FV4 250-750

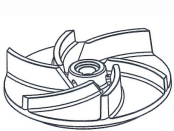

FV 250-4 T
300-4 T
400-4 T

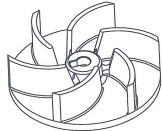

FVT 550-4 T
750-4 T

Free passage: 50 mm

COMPONENTS	MATERIALS
Motor housing, hydraulic part	Grey cast iron
Shaft (pump side)	Stainless steel
Motor side mechanical seal	Carbon - ceramic
Pump side mechanical seal	Silicon carbide
Bolts	A2 stainless steel
Foot support	Galvanize iron
Gaskets (O-Ring)	NBR rubber

CHARACTERISTICS	
Electric motor	Asynchronous, oil immersed
Liquid temperature	0 - 40 °C
Insulation Class	F
Protection	IP 68
Cable	10 m. - H07 RNF

Mobile installation
FV-4 250 ÷ 750

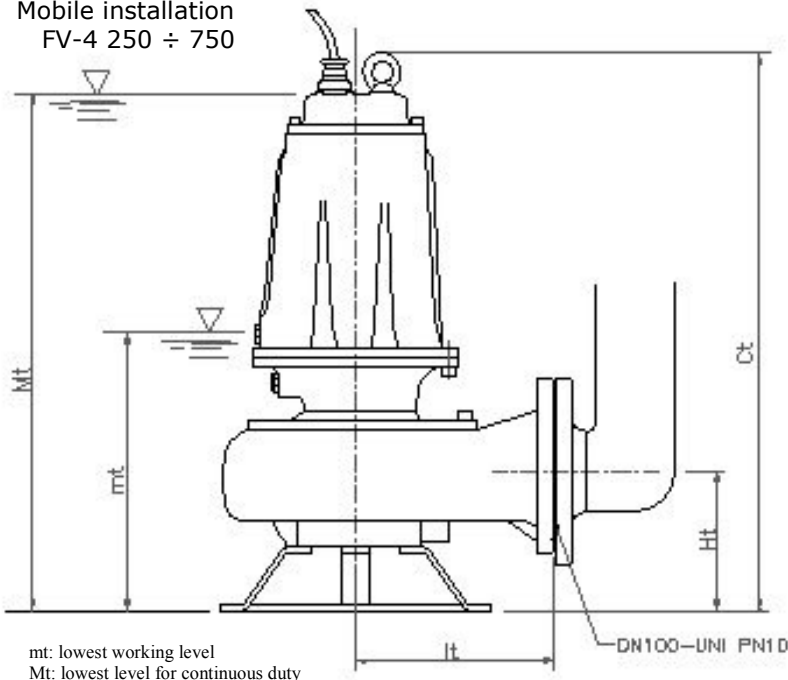

mt: lowest working level
Mt: lowest level for continuous duty

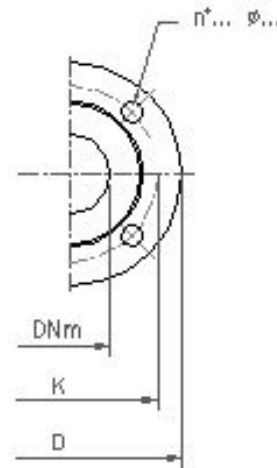

Depth of immersion:
Max 20 m

ACCESSORIES:
Counterflange

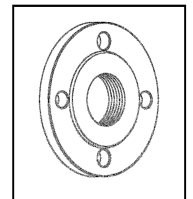

TYPE	DIMENSIONS (mm)					Flange UNI PN 10			Weight Kg
	Ct	Ht	Lt	mt	Mt	DNm	K	D	
FV 250-4 T	660	165	235	300	614	100	180	220	68
FV 300-4 T	660	165	235	300	614	100	180	220	70
FV 400-4 T	660	165	235	300	614	100	180	220	72
FV 550-4 T	715	195	276	385	695	100	180	220	103
FV 750-4 T	715	195	276	385	695	100	180	220	106

ACCESSORIES:

Quick coupling kit

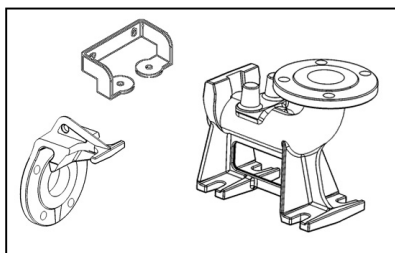

Fixed installation with quick coupling kit
FV-4 250 ÷ 750/ P

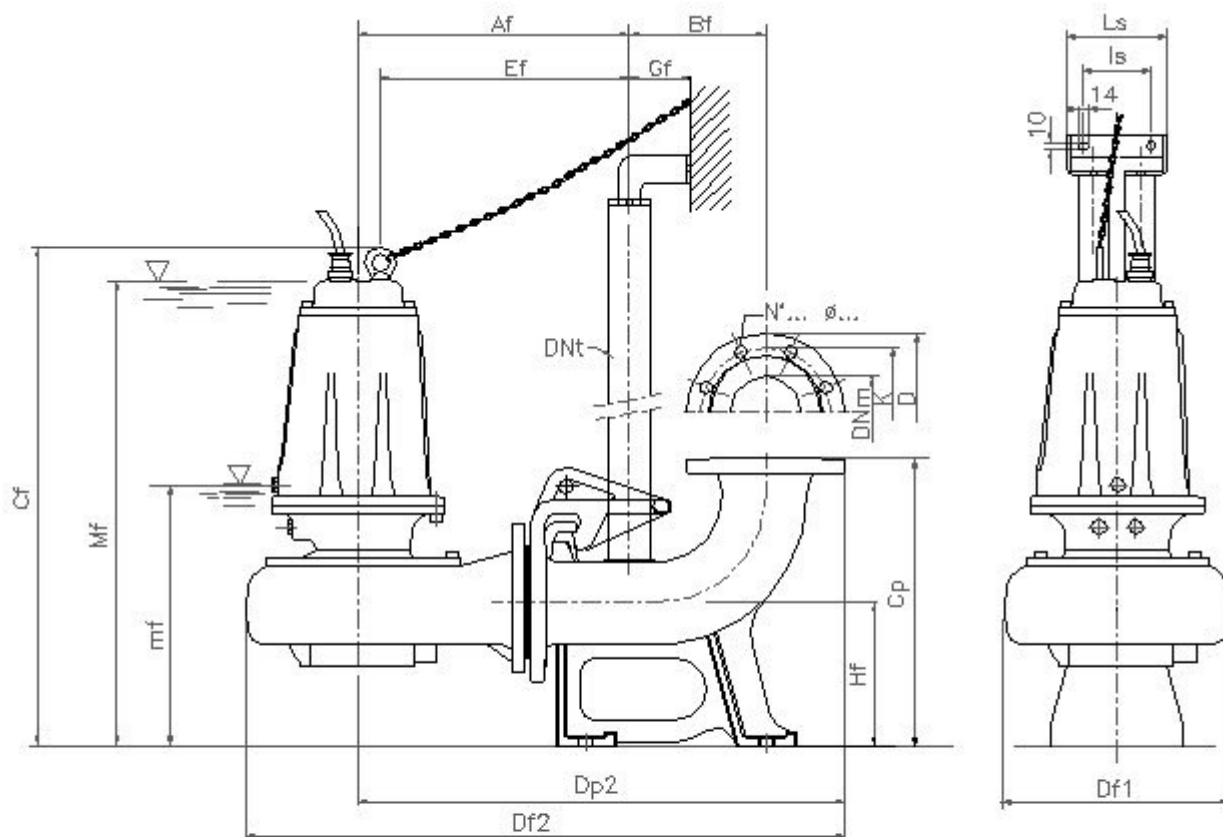

mf: lowest working level
Mf: lowest level for continuous duty

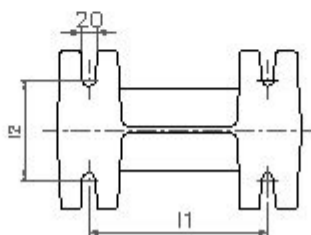

TYPE	DIMENSIONS (mm)															Flange UNI PN 10				
	Af	Bf	Cf	Cp	Df1	Df2	Dp2	DNt	Ef	Gf	Hf	l1	l2	l3	l4	mf	Mf	DNm	K	D
FV 250-4/P T	378	190	695	400	317	835	678	2"	347	85	200	250	140	130	180	335	650	100	180	220
FV 300-4/P T	378	190	695	400	317	835	678	2"	347	85	200	250	140	130	180	335	650	100	180	220
FV 400-4/P T	378	190	695	400	317	835	678	2"	347	85	200	250	140	130	180	335	650	100	180	220
FV 550-4/P T	417	190	755	400	371	900	717	2"	387	85	200	250	140	130	180	390	700	100	180	220
FV 750-4/P T	417	190	755	400	371	900	717	2"	387	85	200	250	140	130	180	390	700	100	180	220

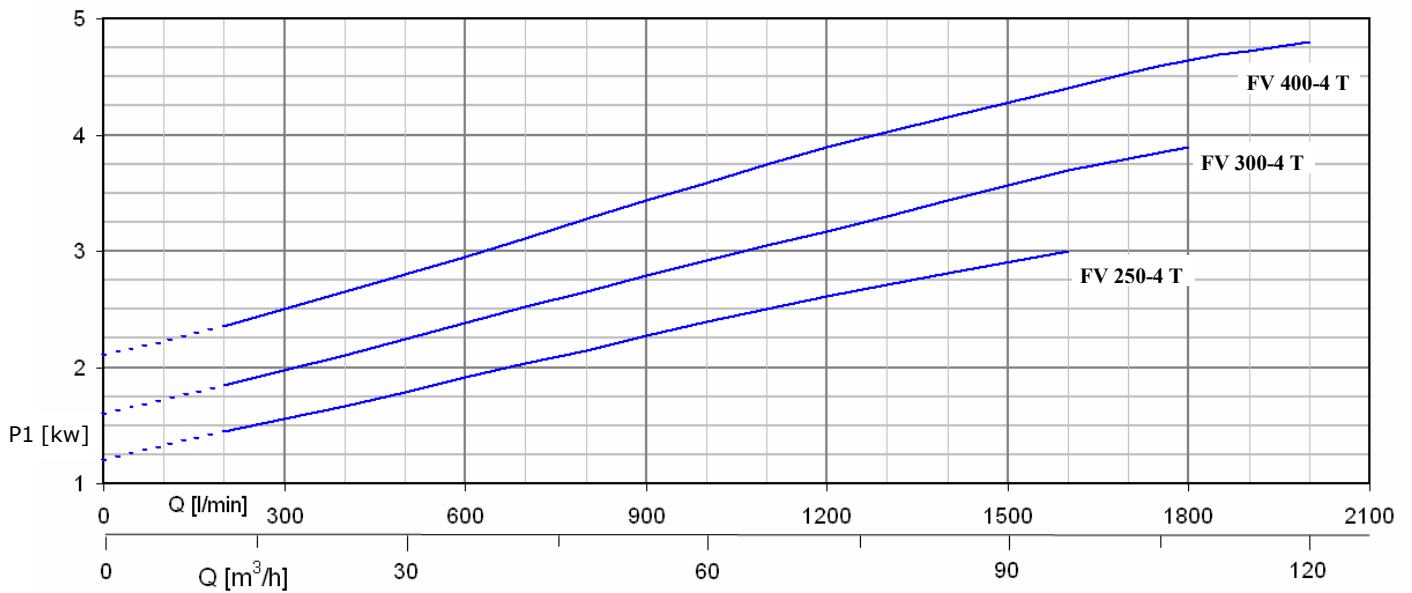
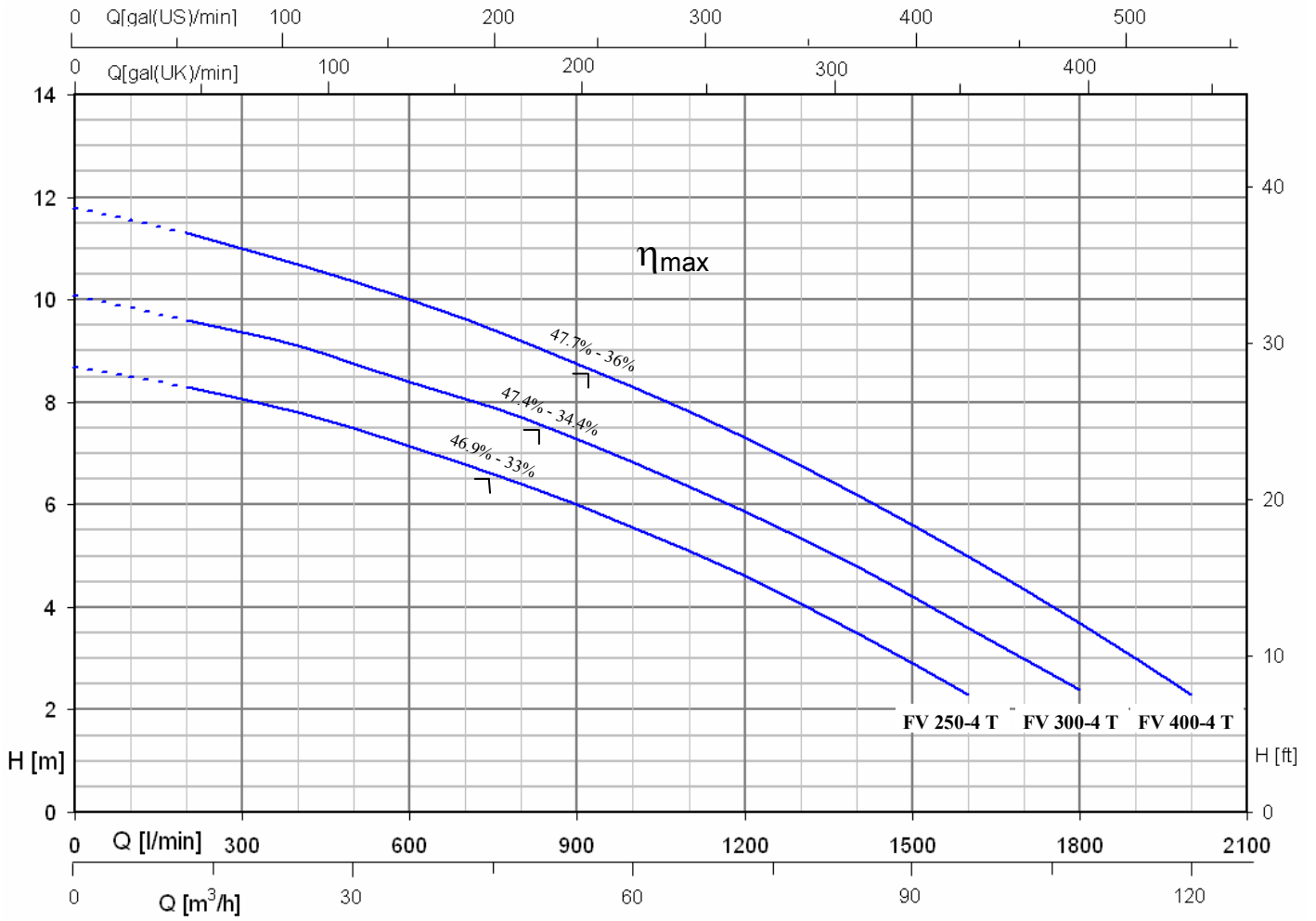

TYPE	P ₂		P ₁ (kW)	A	Q (m ³ /h - l/min)											
					0	12	24	36	48	60	72	84	96	108	120	
3 ~					0	200	400	600	800	1000	1200	1400	1600	1800	2000	
3 X 400 V - 50 Hz	(HP)	(kW)	3~	3X400V 50Hz	H (m)											
FV 250-4 T	2	1.5	3.3	5.8	8.7	8.3	7.8	7.1	6.4	5.5	4.6	3.5	2.3	-	-	
FV 300-4 T	3	2.2	4.1	6.8	10.1	9.6	9	8.4	7.7	6.8	5.8	4.8	3.6	2.4	-	
FV 400-4 T	4	3	4.9	8.7	11.8	11.3	10.7	10	9.2	8.3	7.3	6.2	5	3.7	2.3	

⌋ : η max Max hydraulic efficiency and respective total efficiency

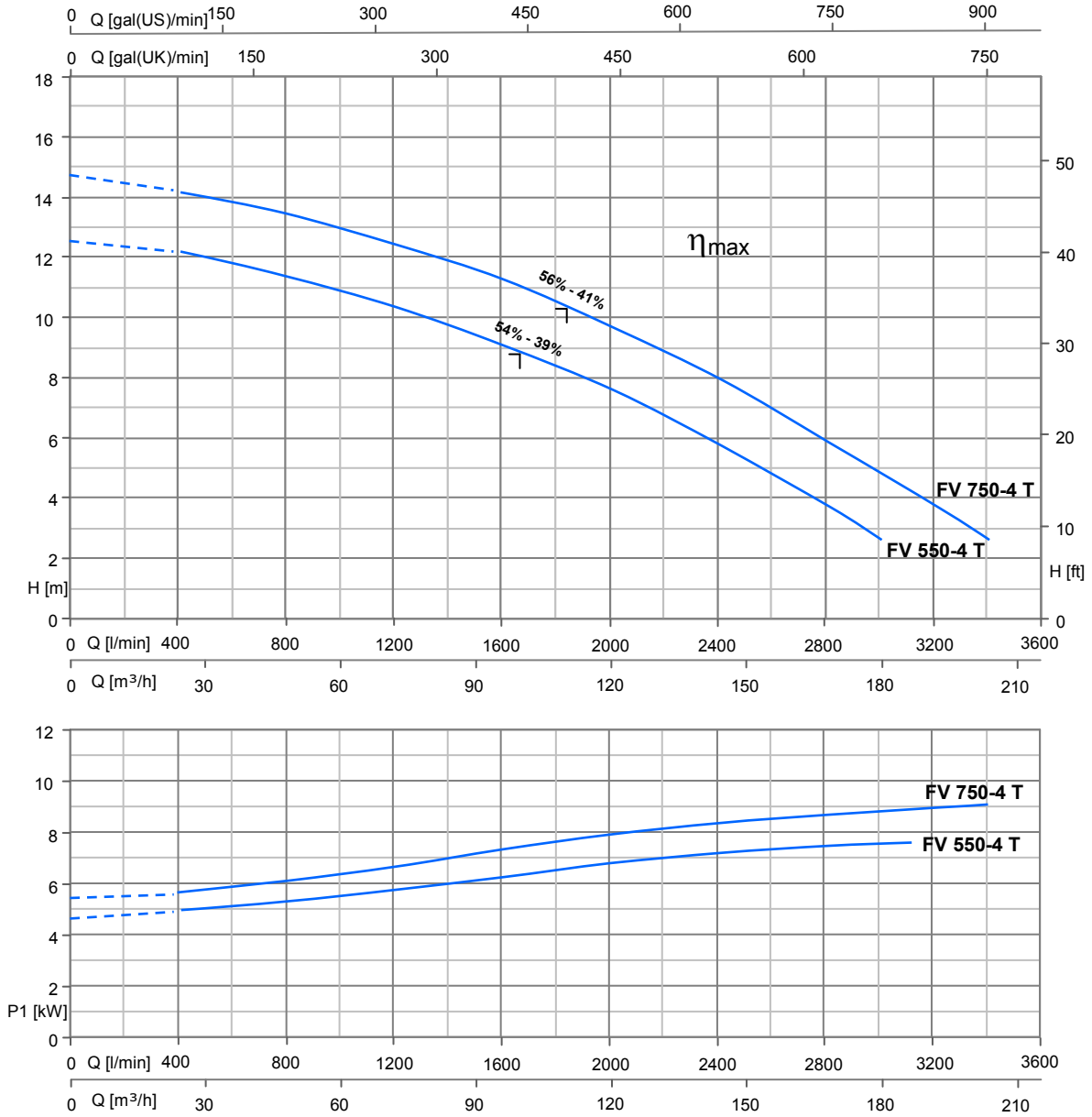

TYPE	P ₂		P ₁ (kW)	A	Q (m ³ /h - l/min)											
					0	24	48	72	96	120	144	168	180	192	204	
3 ~					0	400	800	1200	1600	2000	2400	2800	3000	3200	3400	
400 / 690 V - 50 Hz	(HP)	(kW)	3~	3X400V 50Hz	H (m)											
FV 550-4 T	5.5	4	7.5	12.9	12.6	12.2	11.4	10.3	9.1	7.6	5.7	3.7	2.6	-	-	
FV 750-4 T	7.5	5.5	9	15.4	14.7	14.2	13.3	12.4	11.2	9.6	7.9	5.9	4.8	3.7	2.6	

⌋ : η_{max} Max hydraulic efficiency and respective total efficiency